



# Primer - Liquid Products

## Sealants, Foams and Adhesives

### Waterproofing with liquid products









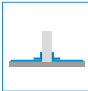

Soprema offers a complete range of liquid waterproofing products and special resins successfully used either in alternation or combination with traditional waterproofing systems with prefabricated membranes.

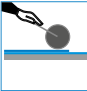
The range includes liquid waterproofing membranes, protective and cool roof system coatings, bitumen and polyurethane sealants and specific adhesives for insulation panels and bitumen membranes.

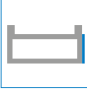
The main applications of Soprema liquid products include:

- New roofs
- Ballasted roofs with wood or tiled flooring
- Existing damaged roofs developed with bitumen or synthetic membranes
- Green roofs
- Planters
- Cool Roofs
- Protection and restoration of metal or fibre cement roofs
- Vertical reliefs on roofs developed with bitumen membranes
- Balconies and terraces

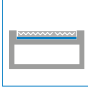
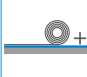
### Key for intended uses

	Vertical turn-ups		Details and emerging bodies		Tileable
	Protective coating/maintenance		Walkable		Emergency repairs
	External wall protection		Internal wall protection		Cool roofs
	Water containment		Adhesive for horizontal elements		
	Adhesion promoter		Anti-root		



# Bituminous Primers

## Primer

Bituminous paint made from special oxidised bitumen and selected, non-recovered solvents. The Primer sets with the evaporation of the solvent, leaving an impermeable film that doesn't drip at high temperatures, and isn't brittle at low temperatures.

Consumption: 250 / 300 g/m<sup>2</sup> approx.

Code	Net contents	Colour	N. Packs/pallet
158312	18 L	Black	44

Adhesion promoter for bitumen membranes



## Rapid Primer

A bituminous paint made from oxidised bitumen and pure and selected solvents, ideal for solving urgent works, where the primer necessarily needs to dry as quickly as possible to allow the immediate application of bitumen membranes. Rapid Primer has a **very quick drying time** of about 5 minutes. Rapid Primer sets with the evaporation of the solvents, leaving an impermeable film that doesn't drip at high temperatures, and isn't brittle at low temperatures.

Consumption: 250 g/m<sup>2</sup> approx.

Code	Net contents	Colour	N. Packs/pallet
113859	18 L	Black	44

Quick-drying adhesion promoter for bitumen membranes



## Primer Base

Bituminous solution made from oxidised bitumen and technical solvents. The product is characterised by adequate adhesion to the substrate. Moreover, once applied, the product is not sticky on the surface.

Consumption: 250 / 300 g/m<sup>2</sup> approx.

Code	Net contents	Colour	N. Packs/pallet
231989	5 L	Black	55
232466	18 L	Black	44

Adhesion promoter for bitumen membranes



## Bituminous Primers

### Aquadere



Quick-drying water-based elastomeric bitumen emulsion with high dry residual weight. Aquadere is a cold-applied adhesion promoter for substrates in concrete, degreased metal or wood, which ensures the adhesion of bitumen-based waterproofing products applied hot or with a propane gas torch.

Consumption: 250 / 300 g/m<sup>2</sup> approx.



Code	Net contents	Colour	N. Packs/pallet
33925	25 L	Brown Black	27

Adhesion promoter for bitumen membranes



### Elastocol 600

A cold-applied adhesion promoter for substrates in concrete, metal or wood, which promotes the adhesion of self-adhesive torchless bitumen membranes.

Consumption: 0.20-0.30 l/m<sup>2</sup> approx. for substrates in metal, and 0.30-0.40 l/m<sup>2</sup> approx. on corrugated and porous substrates (concrete or wood)



Code	Net contents	Colour	N. Packs/pallet
31008	5 L	Black	120
31033	30 L	Black	24

Adhesion promoter for bitumen membranes



# Flashing System

## Alsan Flashing



Product with CE Marking pursuant to **ETA-08/0114**,  
**CUAP 04.20-20:2007**

Single component bitumen/polyurethane resin applied without primer, with the help of a roller or brush (large). Applied with special reinforcement fabrics **Voile Flashing** or **Alsan Fleece**, it is used on all vertical turn-ups in new constructions and refurbishments. Extremely compatible with all self-protecting slate membranes and many other Soprema bituminous systems.

It perfectly joins substrates in clay/cement, metal, wood, expanded perlite, cellular glass. It is resistant to UV rays.

Consumption: 1.8 / 2.1 kg/m<sup>2</sup>

Code	Weight kg	Colour	N. Packs/pallet
033996	2.5 Kg	Brown Black	126
031447	5 Kg	Brown Black	60
011590	15 Kg	Brown Black	30

### Waterproof junctions with bitumen membranes

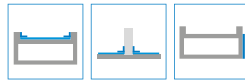

## Alsan Flashing Jardin



Product with CE Marking pursuant to **ETA-08/0114**,  
**CUAP 04.20-20:2007**

This is the additivated version of Alsan Flashing with Anti-root components. Ideal for the waterproofing of planters, green roof elements and surfaces in contact with soil.

Consumption: 1.8 / 2.1 kg/m<sup>2</sup>

Code	Weight kg	Colour	N. Packs/pallet
033990	15 Kg	Brown Black	30

### Anti-Root Junctions for planters and green roofs



# Alsan Flashing Quadro System

## Alsan Flashing Quadro



Extremely adhesive, solvent-based, single-component polyurethane resin, designed for use on details and junctions between horizontal surfaces and vertical elements, on corners, joints, junctions between different materials, and anywhere at risk of cracking. Requires the specific Alsan Fleece reinforcement as indicated on the technical data sheet. It is also possible to develop **W3 waterproofing systems (25-year durability, in compliance with Standard ETAG 005)**, using the specific **Alsan Fleece** reinforcement indicated in the specific ETA Certification. It is tileable. No primer is required on: slated membranes and other Soprema bituminous systems, wooden supports, rigid PVC and mineral substrates (concrete, stone, etc.), various types of metal (see primers chart on [soprema.it](http://soprema.it)). Primer for details on FPO/TPO/EPDM membranes: ALSAN 103 after verifying adherence.

Consumption: 2.0 kg/m<sup>2</sup>.

Code	Weight kg	Colour	N. Packs/pallet
108958	5 Kg	Grey	60

Waterproofing of junctions and small flat surfaces, tileable.

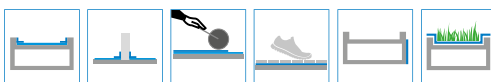

## Alsan 103

ALSAN 103 is a single component polyurethane resin to be used as a base coat for TPO/FPO membranes in combination with the Alsan Flashing Quadro system.

Consumption: Approx. 100 - 150 g/m<sup>2</sup>

Code	Net contents	Colour	N. Packs/pallet
105236	1 L	Transparent	240

Adhesion promoter for bitumen membranes



## Alsan 104 Spray

ALSAN 104 Spray is a single-component alkyd resin that can be sprayed as a primer for metal substrates.

Consumption: Approx. 40 - 100 g/m<sup>2</sup>

Code	Net contents	Colour	N. Packs/pallet
110956	0.5 L	Grey	-
110955	2.5 L	Grey	-

# Alsan 600 System



## Alsan 600



ALSAN 600 is a solvent-based, single-component polyurethane resin for waterproofing different kinds of horizontal surfaces (concrete, bituminous membranes, old ceramic coatings, etc.). ALSAN 600 systems are compliant with ETAG 005 requirements as visible waterproofing systems with W2 (10 years) or W3 (25 years) durability and P3 (normal) or P4 (intensive) walkability. ALSAN 600 is also tileable

Consumption: Approx. 1.6 - 3 Kg/m<sup>2</sup>

Code	Net contents	Colour (RAL)	N. Packs/pallet
151641	5 Kg	1001-7032-7040	60
151645	15 Kg	1001-7032-7040	30

Protective, tileable and walkable coating.



## Alsan Primer H80

Alsan Primer H80 is a single-component polyurethane adhesion promoter for Alsan waterproofing systems.

Consumption: Approx. 100 - 150 g/m<sup>2</sup>

Code	Net contents	Colour	N. Packs/pallet
031534	5 Kg	Transparent	60
031607	20 Kg	Transparent	20

Adhesion promoter for bitumen membranes



## Alsan 140 Kit

Alsan 140 Kit is a fast-drying, two-component polyurethane adhesion promoter for ALSAN liquid waterproofing systems

Consumption: Approx. 200 - 400 g/m<sup>2</sup>

Code	Net contents	Colour	N. Packs/pallet
112393	Composite resin A - 2.5 kg	Transparent	60
112394	Composite hardener B - 2.5 kg	Transparent	120

Adhesion promoter for bitumen membranes



# Alsan 600 System

## Alsan 902 CR

ALSAN 902 CR is a white reflective coating made from pure hydrophobic, aliphatic, polyurethane resins with excellent mechanical, chemical, thermal properties and insensitivity to UV rays and natural agents. It can be used to protect liquid polyurethane waterproofing such as ALSAN 600 and make Cool Roof systems.

Consumption: 200 to 500 g/m<sup>2</sup> per coat

Code	Net contents	Colour (RAL)	N. Packs/pallet
160414	5 Kg	9016	60

Protective coating for liquid waterproofing



## Alsan 902 F

ALSAN 902 F is a coating made from pure hydrophobic, aliphatic, polyurethane resins with excellent mechanical, chemical, thermal properties and insensitivity to UV rays and natural agents. It can be used to protect liquid polyurethane waterproofing such as ALSAN 600.

Consumption: 200 to 500 g/m<sup>2</sup> per coat

Code	Net contents	Colour (RAL)	N. Packs/pallet
102982	15 Kg	1001-1014-7032-7040	60

Protective coating for liquid waterproofing



## Alsan 902 FT

ALSAN 902 FT is a coating made from pure transparent, aliphatic, polyurethane resins. It can be used for the visible protection of tiled and non-tiled floors or as a base for pigmenting the finish with ALSAN 902 CP coloured paste.

Consumption: 200 to 500 g/m<sup>2</sup> per coat

Code	Net contents	Colour (RAL)	N. Packs/pallet
151646	4.5 Kg	Transparent	60

Protective coating for tiled floors



## Alsan 902 CP + Alsan 902 FT

ALSAN 902 CP is a coloured paste to be used as a ALSAN 902 FT resin pigmentation kit

Code	Net contents	Colour	N. Packs/pallet
151646	Alsan 902 FT - 4.5 kg	Transparent	60
151647	Alsan 902 CP - 0.5 kg	1001-1015-7030-7032-7038-7045	120

Protective coating





# Texpur System

## Texprimer A+B



TEXPRIMER is a two-component water-soluble low-viscosity and odourless epoxy primer. TEXPRIMER is used with polyurethane liquid waterproofing systems such as TEXPUR on absorbent and non-absorbent substrates.

Mix  
Consumption: 0.1 - 0.2 kg/m<sup>2</sup>

Code	Weight kg	Colour	N. Packs/pallet
71443	1 + 3 Kg	Amber	84
71441			

Primer for polyurethane liquid waterproofing systems



## Texpur

TEXPUR is a single component polyurethane resin with liquid application, highly elastic, which can be applied cold and used for waterproofing.

TEXPUR is a versatile membrane for a broad range of uses as an integral part of liquid waterproofing systems. Available in red and grey. It is resistant to UV rays.

Consumption: 1.50 - 2.5 kg/m<sup>2</sup> approx. in 2/3 layers

Code	Weight kg	Colour	N. Packs/pallet
119142	6 Kg	Red and Grey	25 boxes of 4 cans each per pallet
71445	25 Kg	Red, Grey or White	25 cans per pallet

Polyurethane liquid waterproofing systems



Product with CE Marking pursuant to ETA 14/0484

## Texcap F

TEXCAP F is a coating made from pure elastomeric, hydrophobic, aliphatic, polyurethane resins with excellent mechanical, chemical, thermal properties, resistant to UV rays and natural agents, and can be applied cold. It can be used to protect liquid polyurethane waterproofing such as TEXPUR. It has excellent weather resistance and excellent colour stability/protection. It dries by reaction with substrate and air moisture. Available in light grey, dark grey and red. It is resistant to UV rays.

Consumption: 0.12 - 0.25 kg/m<sup>2</sup> approx. in 1/2 layers

Code	Weight kg	Colour	N. Packs/pallet
071434	5 Kg	White, Grey, Red, Light Grey	144 cans per pallet

Coloured finish for polyurethane liquid waterproofing systems

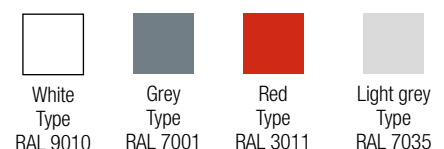

# Texpur System

## Texcap FT



TEXCAP FT is a coating made from pure elastomeric, hydrophobic, aliphatic, polyurethane resins with excellent mechanical, chemical, thermal properties, resistant to UV rays and natural agents, and can be applied cold. It is transparent and can be used for the visible protection of tiled and non-tiled floors. It has excellent weather resistance and excellent colour stability/protection. Dries by reaction with substrate and air moisture.

Consumption: 0.8 - 0.12 kg/m<sup>2</sup> approx. in 2/3 layers. Shake the product until obtaining a consistent mix.

Code	Weight kg	Colour	N. Packs/pallet
071436	5 Kg	Transparent	144 cans per pallet

## Texkat

Accelerating catalyst for Texpur system.

Consumption: depending on external temperature, check technical data sheet.



Code	Net contents	Colour	N. Packs/pallet
71460	1 Kg	Transparent	432 cans per pallet

# Waterproof coatings



UNI EN 1504-2 and UNI EN 14891

## Alsan Flashing Easylastic

ALSAN Flashing Easylastic is a water-based, multi-purpose waterproofing product formulated with bitumen, selected elastomeric resins and special additives; it is resistant to weathering and UV rays, is used to waterproof, protect different types of surfaces and make under-tile waterproofing systems in compliance with UNI EN 14891.

Consumption: 1.5 to 2.5 kg/m<sup>2</sup>

Code	Weight kg	Colour	N. Packs/pallet
231070	5 Kg	RAL 7037-8007	100
231070	5 Kg	Reflex White	100
231071	20 Kg	RAL 7037-8007	33
231071	20 Kg	Reflex White	33

Waterproofing of junctions and small flat surfaces, tileable.



UNI EN 1504-2 and UNI EN 14891

## Easy Flashing



Multi-purpose, bituminous, thixotropic waterproofing coating featuring high adhesion capacity and flexibility even at low temperatures. It can be applied with or without TNT reinforcement. It is compatible with the majority of construction materials (cement, wood, bitumen, metal, rigid PVC, etc.). Water-based, odourless, it can also be used directly on solvent-sensitive materials such as EPS/XPS panels.

Consumption: 1.5/2.0 kg/m<sup>2</sup> approx. (for two layers)

Code	Weight kg	Colour	N. Packs/pallet
117111	310 ml	Black	24
117106	1 Kg	Black	18
117107	5 Kg	Black	100
117108	10 Kg	Black	55
117109	20 Kg	Black	33

Liquid membrane for waterproofing various types of substrates



Product with CE Marking pursuant to ETA 14/0134  
EN15814 - ETAG005

## Easygum



EASYGUM is a ready-to-use, black, semi-dense, thixotropic, bitumen paste. A new, environmentally-friendly system for repairing deteriorated waterproofing systems, sealing technical parts, waterproofing metal and concrete surfaces. It can be used to bond any type of insulation panel onto concrete or breathable surfaces. It is resistant to UV rays.

Consumption: 2.0 kg/m<sup>2</sup> approx. (for two layers)

Code	Net contents	Weight kg	Colour	N. Packs/pallet
118727	9.15 L	10 Kg	Black	55
118728	18.45 L	20 Kg	Black	44

Liquid membrane for waterproofing various types of substrates



# Waterproof coatings



## Campolin



Elastomeric waterproofing coating, made of acrylic copolymers in water emulsion compliant with DMS 20/08/1999 as an encapsulating system (type A- B - C) for asbestos cement. Protects the substrate against UV rays

Consumption: 600 / 800 g/m<sup>2</sup>

Code	Weight kg	Colour	N. Packs/pallet
110717	20 Kg	9010 - 7004 - 8023 - 6010 - 3002	27

Protective coating.



## Campolin Fiber



Elastomeric waterproof coating, made from acrylic copolymers in aqueous emulsion, reinforced with polypropylene fibres that allow application without reinforcement. With a minimum thickness of 1.3 mm, it is walkable-resistant according to cat. P3 - Etag 005. Protects the substrate against UV rays. The substrate must guarantee proper rainwater drainage.

**The product is not resistant to stagnant water.** Available in White/Grey/Terracotta/Green

Consumption: 600 / 700 g/m<sup>2</sup> approx. (per layer)

Code	Weight kg	Colour (RAL)	N. Packs/pallet
110717	5 Kg	9010 - 7004 - 8023 - 6010 - 3002	100
110719	20 Kg	9010 - 7004 - 8023 - 6010 - 3002	27

Walkable liquid membrane

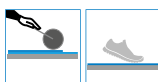

Product with CE marking compliant with standard **EN13813**



## Emufal Solid



EMUFAL SOLID is a thick bitumen coating modified by special additives, in aqueous emulsion. It offers high viscosity and consistency and is used as a coating, protection for foundations, etc., or as a bitumen treatment to protect various types of surfaces and concretes. It is water-soluble. Easy to apply with a trowel, roller, brush, and adheres to wet surfaces.

Consumption: 250 g/m<sup>2</sup> approx.

Code	Weight kg	Colour	N. Packs/pallet
114178	25 Kg	Black	22

Thick bitumen coating





# Waterproof protections



Product with CE Marking compliant with Standard EN1504-2 - 0505 - CPR-1207

## White Reflecta Plus

Ready-to-use protective and decorative paint, formulated with special synthetic resins that form a film able to follow the deformations and expansions of the waterproofing materials on which it is applied. Its high reflectivity reduces heat absorption, with subsequent energy savings in terms of the building's cooling systems. Protects the substrate against UV rays.

Consumption: 300 / 400 g/m<sup>2</sup> approx. (per layer)

Code	Weight kg	Colour	N. Packs/pallet
154971	18 Kg	White Reflecta	33

### High reflectance coating



## Cural

Semi-dense formula made with elastomeric bitumen, aluminium pigments, fibres, mineral fillers and volatile solvents. It is used as a bitumen coating for the refurbishment and renewal of existing waterproofing systems. The special pigmentation of CURAL is designed to make the product look like aluminium. Protects the substrate against UV rays.

Consumption: 300 g/m<sup>2</sup> approx.

Code	Weight kg	Colour	N. Packs/pallet
33928	5 Kg	Aluminium	90
31354	25 Kg	Aluminium	30

### High-performance formula for protection and maintenance of bitumen membranes



## Aluminium Paint

Bituminous aluminium paint with high hiding and reflective power characterised by a high adhesion coefficient on all bituminous surfaces. Its ideal application is as a protective paint for bitumen membranes. Protects the substrate against UV rays.

Consumption: 0.3 kg/m<sup>2</sup> approx.

Code	Net contents	Weight kg	Colour	N. Packs/pallet
232563	4500 ml	5 Kg	Aluminium	100
232562	16.45 L	18 Kg	Aluminium	44

### Protection and Maintenance of bitumen membranes



## Waterproof protections

### Eco Color



Coloured coating made of selected synthetic resins in aqueous dispersion and special additives. It offers high viscosity and consistency and is used as a coating, protection for foundations, etc., or as a bitumen treatment to protect various types of surfaces and concretes. It is water-soluble. Easy to apply with a trowel, roller, brush, and adheres to wet surfaces.

Consumption: 400 to 700 g/m<sup>2</sup>

Code	Weight kg	Colour	N. Packs/pallet
232111	5 Kg	Red	55
232111	5 Kg	Grey - Green	55
113980	20 Kg	Red	33
113980	20 Kg	Grey - Green	33

### Protective coating



## Liquid Products - Accessories

### Reinforcement fabrics

- Alsan Voile Flashing (waterproof composite reinforcement)
- Alsan Fleece-B (pre-drilled polyester TNT)



PRODUCT	Dimensions m	Length m
Alsan Voile Flashing	50 x 0.10	50 m
Alsan Fleece 110 P 0.15/50 (Alsan Voile P)	50 x 0.15	50 m
Alsan Fleece 110 P 0.20/50 (Alsan Voile P)	50 x 0.20	50 m
Alsan Fleece 110 P 0.25/50 (Alsan Voile P)	50 x 0.25	50 m
Alsan Fleece 110 P 0.50/50 (Alsan Voile P)	50 x 0.50	50 m
Alsan Fleece 110 P 1.05/50 (Alsan Voile P)	50 x 1.05	50 m
Alsan Fleece 165 B	50 x 0.20	50 m
Alsan Fleece 165 B	50 x 1.05	50 m



### Alsan Fleece 225 GF

Glass fibre reinforcement mat

Code	Length	Width
115609	20 cm	50 m
115751	100 cm	50 m



### Fleece Tape BT

Butyl tape bonded to non-woven fabric

Code	Length	Pack
221537	10x15 cm	8 rolls



### Aluband

Self-adhesive butyl sealing tape

Code	Length	Pack
221538	0.6x100 mm x 10 m	6 rolls
221539	0.6x150 mm x 10 m	4 rolls
221010	0.6x75 mm x 10 m	8 rolls
221534	0.6x75 mm x 10 m	8 rolls
221535	0.6x100 mm x 10 m	6 rolls
221536	0.6x150 mm x 10 m	4 rolls



### Multiflex

Waterproof band with side supports in polypropylene fabric for joints and reinforcement of junctions between structures.

Code	Length	Width
155009	12 cm	50 m

## Liquid Products - Accessories

### Filtene

Compactable and anti-adhesive filling element for joints.



Code	Diameter
114156	Ø 10
114566	Ø 20
114567	Ø 30
114157	Ø 40



### Draini Alsan straight Alu

Union for rainwater drain for waterproofed roofs/terraces. It is comprised of a special geotextile applied to an aluminium pipe by means of a patented system.

Code	Diameter	Width
119624	Ø 50	400 m
119625	Ø 63	400 m
119626	Ø 75	400 m
119627	Ø 95	400 m



### Alsan Macaflash

Tool for applying the reinforcement layer in liquid waterproofing systems

Code		
159074		



## Adhesives

### Sopravap 3 in 1



Adhesive for the total adherence of various types of insulation panels, which acts as a vapour barrier and does not require use of a primer. SOPRAVAP 3 in 1 is a two-component polyurethane-based liquid resin that works as a primer, vapour barrier and adhesive. Workable for 30 minutes, it completely sets to light foot traffic in 2 hours.

SOPRAVAP 3 in 1 is supplied in 25 kg kits (component A in 20.7 kg can and component B in 4.3 kg can)

Indicative consumption: minimum 2 kg/m<sup>2</sup> (1.5 mm film after drying and crosslinking), the effective quantity varies depending on the condition of the substrate.

Code	Weight kg	N. Packs/pallet
33947	Comp. A - 20.7 kg	20 kit
33947	Comp. B - 4.3 kg	20 kit

#### Adhesive for sheets

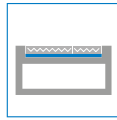

### Sopracol Liquid

Cold-applied, ready-to-use adhesive comprised of a solvent-based thixotropic bituminous binder. SOPRACOL LIQUID is specifically designed for bonding in total adhesion of special bitumen membranes produced by Soprema, with a talc-treated, sandblasted, or Texface-coated surface. Compatible substrates: concrete, wood panels, repairs and relaying of pre-existing slated bitumen membranes.

Consumption: 1.0 kg/m<sup>2</sup> approx.

Code	Weight kg	N. Packs/pallet
33941	25 Kg	30

#### Adhesive for bitumen membranes

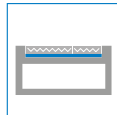

## Adhesives

### Coltack® Evolution

Single component, solvent-free polyurethane adhesive with controlled expansion for applications on flat roofs. It is mainly used to bond solvent-sensitive and non-sensitive insulation panels on various types of substrates. Damp-proof.

Consumption: 200 / 400 g/m<sup>2</sup>



Weight kg	Colour	N. Packs/pallet
750 ml	Amber	12 pieces/box
6 Kg	Amber	84

Adhesive for thermoplastic sheets

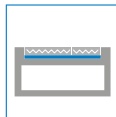

### Sopracolle 300 N

Adhesive paste made from bitumen, polymers and solvents, ready-to-use, ideal for the application of non-solvent-sensitive insulation panels.

Consumption: 400 / 600 g/m<sup>2</sup>



Code	Weight kg	Colour	N. Packs/pallet
30930	25 Kg	Black	30

Adhesive for fibrous sheets

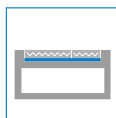



# The Soprema range of sealants and foams

Alsan® Mastic 2200

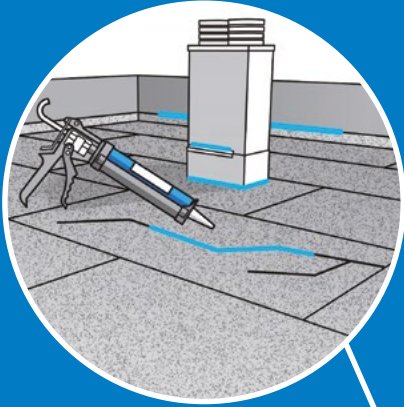

Alsan® Flex 2921 SB



Alsan® Flex 2921 SB

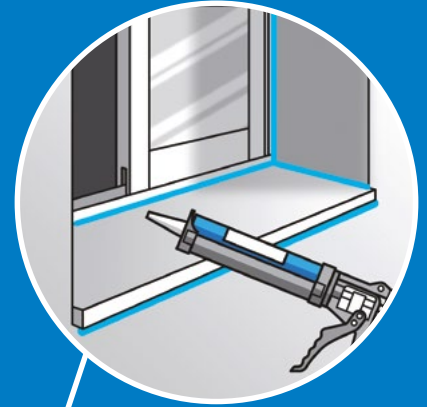

Alsan® Foam EPS/XPS

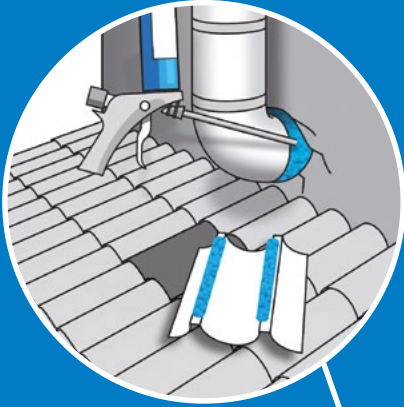

Alsan® Sil 2440 FA

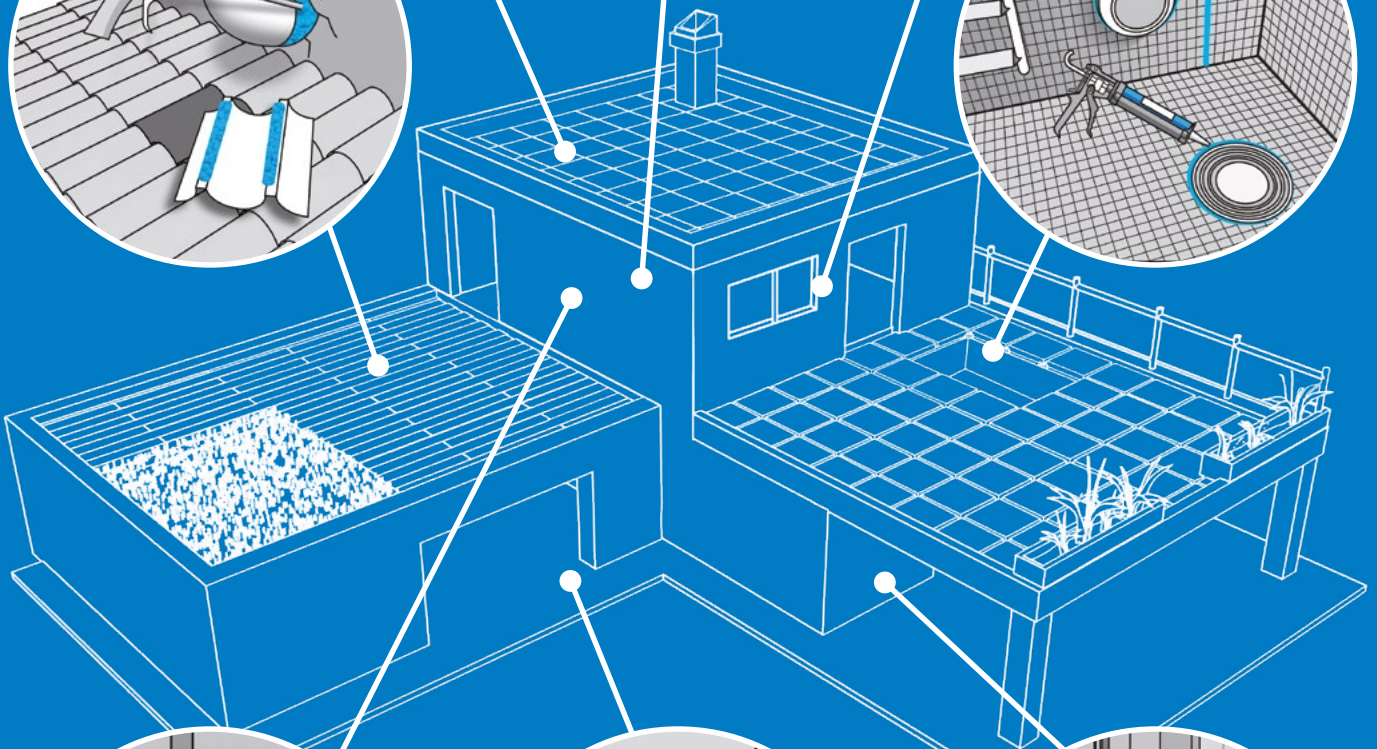
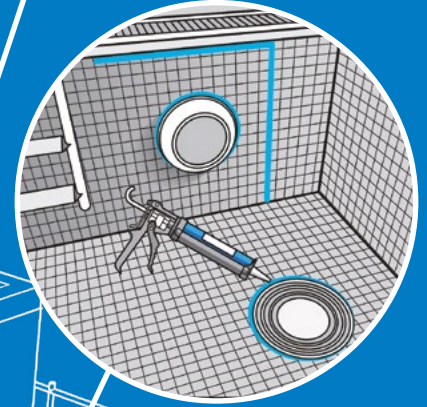

Alsan® Sil 2440 FA

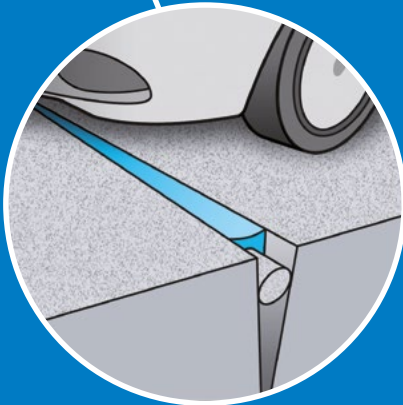

Alsan® Flex 2711 CO



Alsan® Sil 2440 FA

## Sealants



### Alsan Mastic 2200

Non-crosslinkable sealant made from plasticised synthetic rubber with bitumen. Used in addition to bitumen waterproofing systems as a sealant or joint filler. It is compatible with bituminous products and suitable for outdoor use only.

Code	Pack	Colour	Box
099199	Cartridge (CT) 310 ml	Black	20 CT310

Consumption: as needed



### Alsan Flex 2711 CO

Single component, elastic sealant and adhesive. It is a medium modulus polyurethane with excellent adhesion to construction materials. Suitable for both indoor and outdoor applications. Used to seal joints, soundproof pipes and dividing walls. Used as an adhesive to bond tiles, prefabricated elements, etc.

Code	Pack	Colour	Box
152410	Cartridge (CT) 300 ml	White - Grey	12 CT 300
152468	Foil Pack (FP) 600 ml	White - Grey	12 FP 600

Alsan Flex 2711 CO is compliant with:  
 EN 15651 part 1:2012: class F-EXT-INT-CC 25LM  
 EN 15651 part 4: 2012: PW-EXT-INT-CC  
 Classification A + (French VOC regulation)  
 LEED requirements. Low-emission materials: adhesives and sealants. SCAQMD 1168 regulation



### Alsan Flex 2921 SB

Elastic sealant and single-component adhesive. It is a medium modulus hybrid-based polymer. Suitable for both indoor and outdoor applications. Used with materials such as concrete, bricks, ceramics, glass, wood, galvanised and painted iron sheets.

Code	Pack	Colour	Box
152421	Cartridge (CT) 290 ml	White - Grey	12 CT 300

Alsan Flex 2921 SB is compliant with:  
 EN 15651 part 1:2012: F-EXT-INT class 25HM  
 EN 15651 part 4:2012: PW-INT  
 CE Marking – DoP CCHEU1905



### Alsan Sil 2440 FA

Low modulus silicone with neutral polymerisation. It has excellent adhesion to construction materials. It is suitable for both indoor and outdoor applications. Used for the long-lasting sealing of connection and expansion joints; ideal for applications on metal, glass, cement, etc. It can also be used in bathrooms, showers and kitchens.

Code	Pack	Colour	Box
152424	Cartridge (CT) 300 ml	Grey - White - Translucent	12 CT 300

Alsan Sil 2440 FA is compliant with: EN 15651 part 1:2012: F-EXT-INT-CC 25LM  
 EN 15651 part 2:2012: G-CC 25LM - EN 15651 part 3:2012: S XS1  
 Classification A+ (French VOC regulation) - SNJF class F25E



## Foams - Guns



### Alsan Foam EPS/XPS

Single component polyurethane adhesive foam. Used to bond thermal insulation panels such as EPS, XPS and PU, cementitious roof shingles and bent tiles. It has excellent adhesion to construction materials. It is suitable for both indoor and outdoor applications.

Code	Pack	Colour	Box
153062	Spray can 750 ml	Light green	12 PC750G

Alsan Foam EPS/XPS is compliant with:  
Classification A+ (French VOC regulation) - Reaction to fire class B2 (DIN 4102-3) – E (EN 13501-1)



### Alsan Foam UNI

Multipurpose, single component polyurethane foam that provides thermal and acoustic insulation. Used to fix and insulate doors and windows, to seal and grout joints and cavities, insulate electrical sockets and piping. It has excellent adhesion to the most common construction materials. It is suitable for both indoor and outdoor applications.

Code	Pack	Colour	Box
153058	Spray can 750 ml	Yellow	12 PC750G

Alsan Foam UNI is compliant with: Classification A+ (French VOC regulation)



### Alsan Foam CL-F

Multipurpose cleaner, used to dissolve non-polymerised or fresh polyurethane foam. Used to clean foam application guns, work tools and surfaces.

Code	Pack	Colour	Box
153065	Spray can 500 ml	Transparent	12 PC500



### Foam Gun FG ST5

Application gun for foam, fully coated in PTFE (Teflon). Easy to clean and maintain.

Code	Use	Coating	Length
156182	Foam	PTFE (total)	Standard



### Foam Gun FG LG8

Application gun for foam, coated in PTFE (Teflon). The length of the gun allows practical and comfortable application of the foam.

Code	Use	Coating	Length
156183	Foam	PTFE	80 cm



### Caulking Gun CG-CT6

Application gun for cartridges in plastic and aluminium.

Code	Use	Coating	Length
156179	Cartridges		Standard



### Caulking Gun CG-FP4 / FP6

Gun for 600ml non-rigid cartridges (Foil pack).

Code	Use	Coating	Length
156181	Foil pack		Standard

## HEAD OFFICE

---



Via Industriale dell'Isola, 3 - 24040 Chignolo d'Isola (Bergamo)



Tel. +39.035.095.10.11 | Fax +39.035.494.06.49



[info@soprema.it](mailto:info@soprema.it)

## PRODUCTION PLANTS

---

### Insulating Materials



Verolanuova (Brescia)  
San Vito al Tagliamento (Pordenone)  
Frigento (Avellino)



[info.insulation@soprema.it](mailto:info.insulation@soprema.it)

### Synthetic Membranes



Chignolo d'Isola (Bergamo)  
Villa Santo Stefano (Frosinone)



[info@soprema.it](mailto:info@soprema.it)

### Polymer Bitumen Membranes & Waterproofing Liquid Products



Salgareda (Treviso)



[novaglass@soprema.it](mailto:novaglass@soprema.it)



[www.soprema.it](http://www.soprema.it)

